

EZ FABRIC COUNTER STRAIGHT - INSTRUCTIONS

EZ TUBE DISPLAYS

PRODUCT CODE: EZ-STRFABCTR

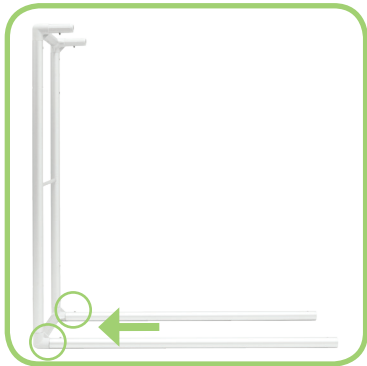
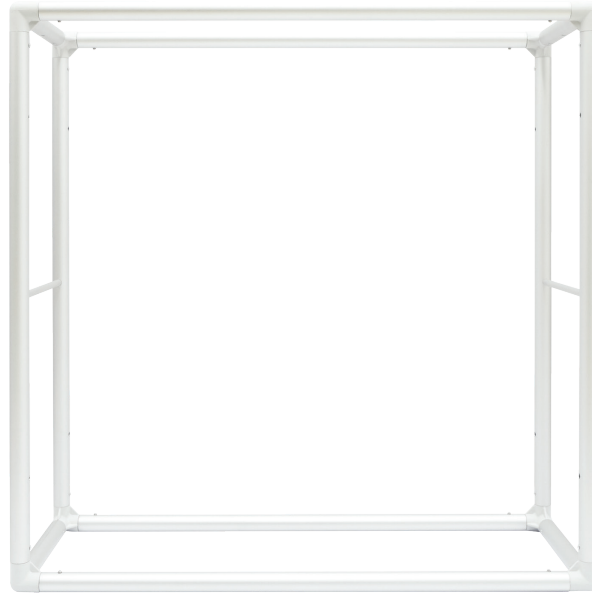

1. Slide the bottom horizontal tubes onto the side of frame.



2. Push snap buttons and slide into hole to secure.

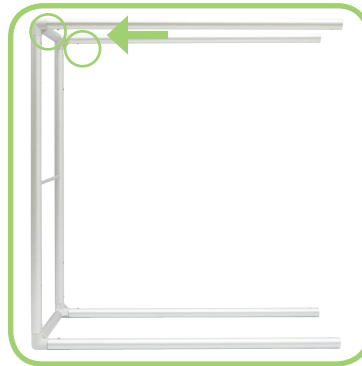

3. Slide the top horizontal tubes onto the side of frame.



4. Repeat to lock tubes.

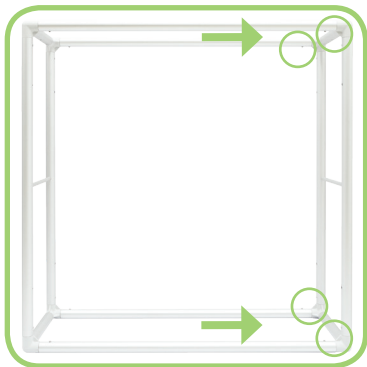

5. Then connect the other side of frame.



6. Unscrew the large head screws on top of the frame.



7. Make sure the holes for the counter are on top before installing the graphic.



8. Drape the graphic over the counter frame.

EZ FABRIC COUNTER STRAIGHT - INSTRUCTIONS

EZ TUBE DISPLAYS

PRODUCT CODE: EZ-STRFABCTR

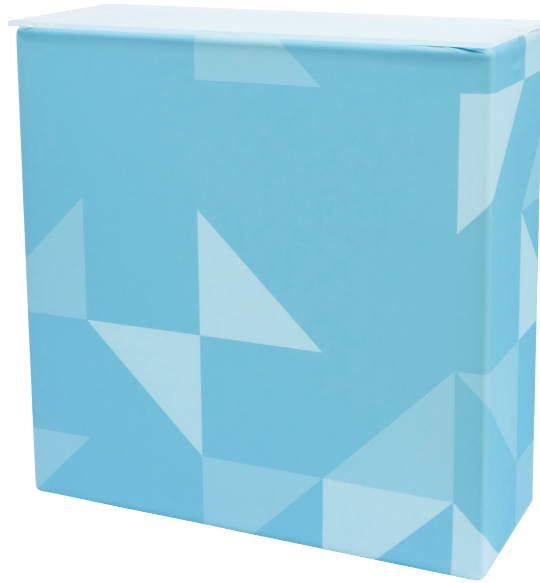

9. Pull down the graphic to cover the whole frame.

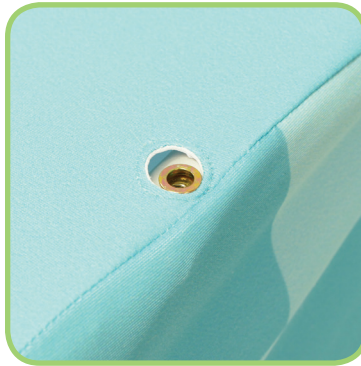

10. Make sure both drill holes are align with the hemmed holes in graphic.

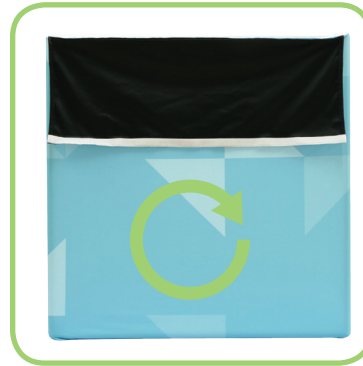

11. Flip over the frame.



12. Using the industrial-size zipper, zip up the back side, maximizing fabric tension.



13. Locate the hook sides of the graphic.



14. Pull over the bottom cover to attach the hook and loop to secure graphic.

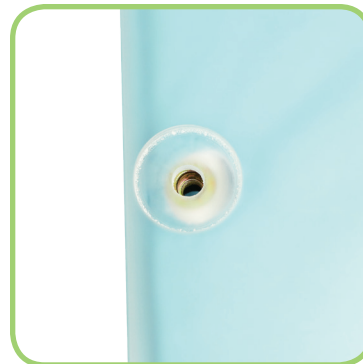

15. Place the acrylic counter top on top of the frame and align the holes.

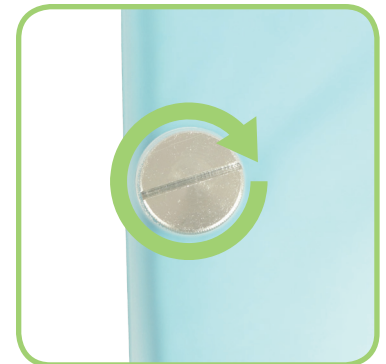

16. Insert the large head screws to secure the counter top to the frame*.